

## LOUVRES - WIND RESISTANT

ISO VIEW



CROSS-SECTIONAL VIEW



FRONT VIEW

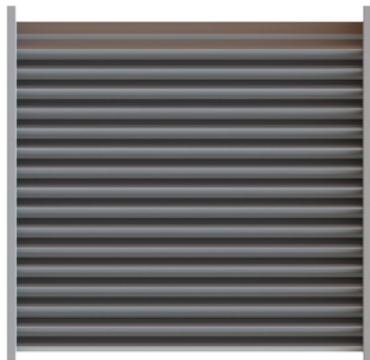

PROFILE VIEW



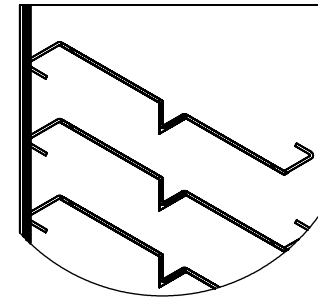
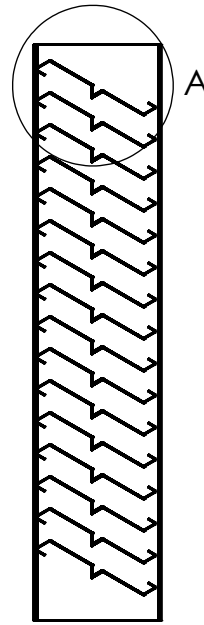
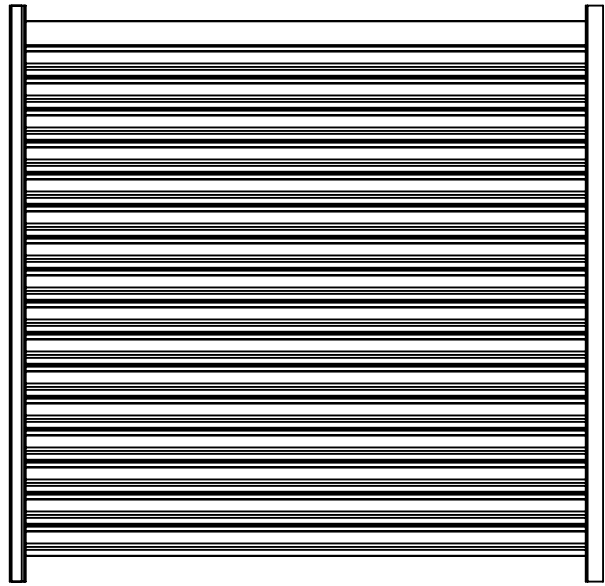

DETAIL A  
SCALE 1 : 5

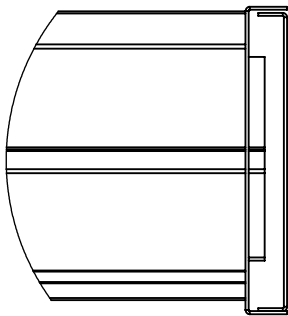
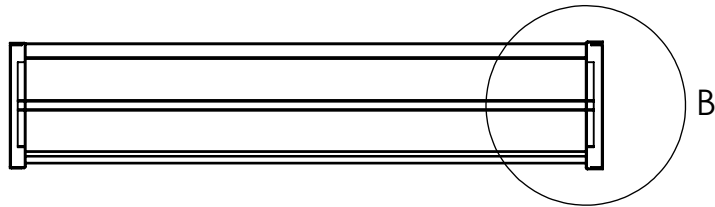
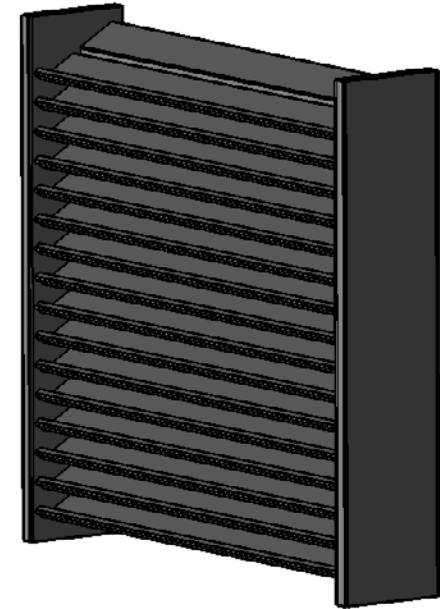

DETAIL B  
SCALE 1 : 5

**PROPRIETARY AND CONFIDENTIAL**  
 THE INFORMATION CONTAINED IN THIS DRAWING IS THE SOLE PROPERTY OF PANELEX INDUSTRIES LD. ANY REPRODUCTION IN PART OR AS A WHOLE WITHOUT THE WRITTEN PERMISSION OF PANELEX INDUSTRIES LTD. IS PROHIBITED.

		DIMENSIONS ARE IN INCHES TOLERANCES: FRACTIONAL ± ANGULAR: MACH ± BEND ± TWO PLACE DECIMAL ± THREE PLACE DECIMAL ±	NAME	DATE	PANELEX INDUSTRIES
			R.R	11/05/14	
		CHECKED		WIND RESISTANT TYP.	
		ENG APPR.			
		MFG APPR.			
		Q.A.			
		MATERIAL: 0.080 ALUMINUM	COMMENTS:		SIZE <b>A</b> SCALE: 1:20
NEXT ASSY	USED ON	FINISH : POST PAINTED ; COLOR AS PER CLIENT REQUEST	FABRICATED LOUVRE BLADES. NO EXPOSED FASTENERS. WELDED TO THE FRAME ( NO VISIBLE WELDS). POST PAINTED IN A DURANAR/DURACRON FINISH. ANY COLOR MATCH POSSIBLE.		
APPLICATION		DO NOT SCALE DRAWING			